

Paws for Books Table Centrepiece Instructions



Supplies*:

- Cardboard
- Hot glue
- Utility knife
- Paint
- Paint brushes



Table Sign Base Directions:

1. Using the utility knife, cut out an 45cm diameter circle from the cardboard. Cut the circle in half so you have two equal semi-circles.
2. Cut out a 17 x 45 cm rectangle to create the base.
3. Cut out two 22 x 8 cm rectangles. Fold in both ends at the 2 cm mark. This piece should measure 17 x 8 cm when folded. Put aside for Step 8.
4. Cut two 20 x 8 cm rectangles and fold these two pieces in half lengthwise. This piece should measure 20 x 4 cm when folded.
5. Using hot glue, adhere one of the 20 x 8 cm panels to the bottom of one of the semi-circles. See **Figure 1** for reference. Attach the second panel to the other semi-circle in the same way.
6. Glue the semi-circle and the base as shown in **Figure 2**.
7. Attach the other semi-circle to the other side of the 17 x 25 cm rectangle. See **Figure 3**.

* Remember, these are only suggestions. This project should be fun and creative, so use supplies you have on hand for substitutions.

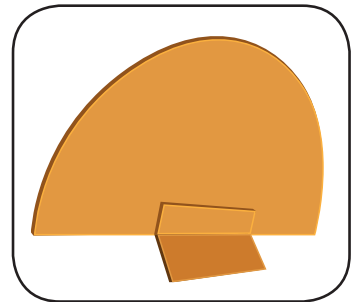

Figure 1

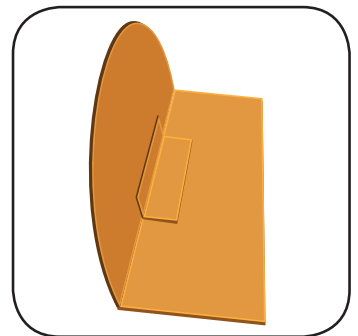

Figure 2

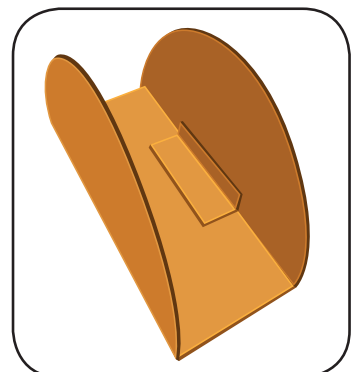

Figure 1

8. Glue the two 17 x 8 cm pieces with the folded 2 cm tabs from Step 3 to connect both sides of the semi-circle as shown in **Figure 4**.

Character decoration directions:

1. Using cardboard, cut out two pieces to make the character ears, like the ones shown in **Figure 1**, and attach on the back side of the front of the face. Refer to the character templates on pages 3–4 for reference for this step.
2. Paint the inside walls to match the character. See **Figure 2**.
3. Use the character templates on pages 3–4 as reference to paint the character faces onto the front panel. Or if desired, you may project the template onto the panel and trace the face, then paint. See **Figure 3**.

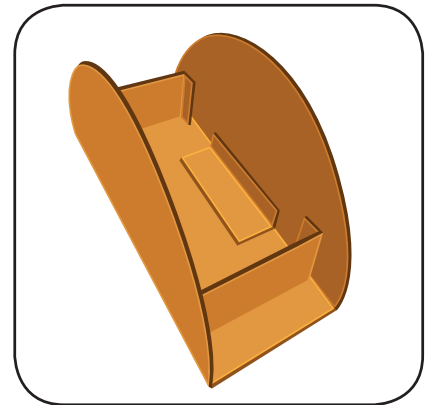

Figure 4

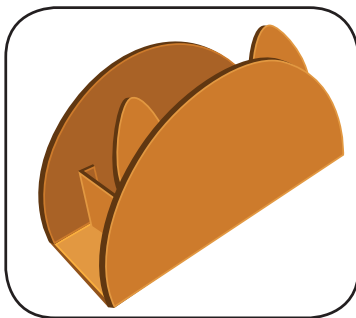

Figure 1

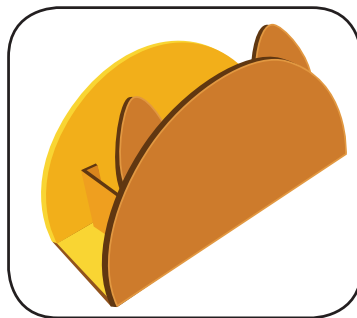

Figure 2

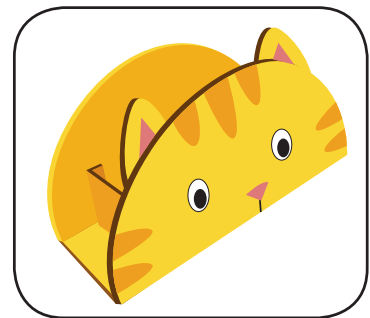

Figure 3







